

A80 4D DRIVE UNIT

Self-aligning rollerbed with 40 ton capacity

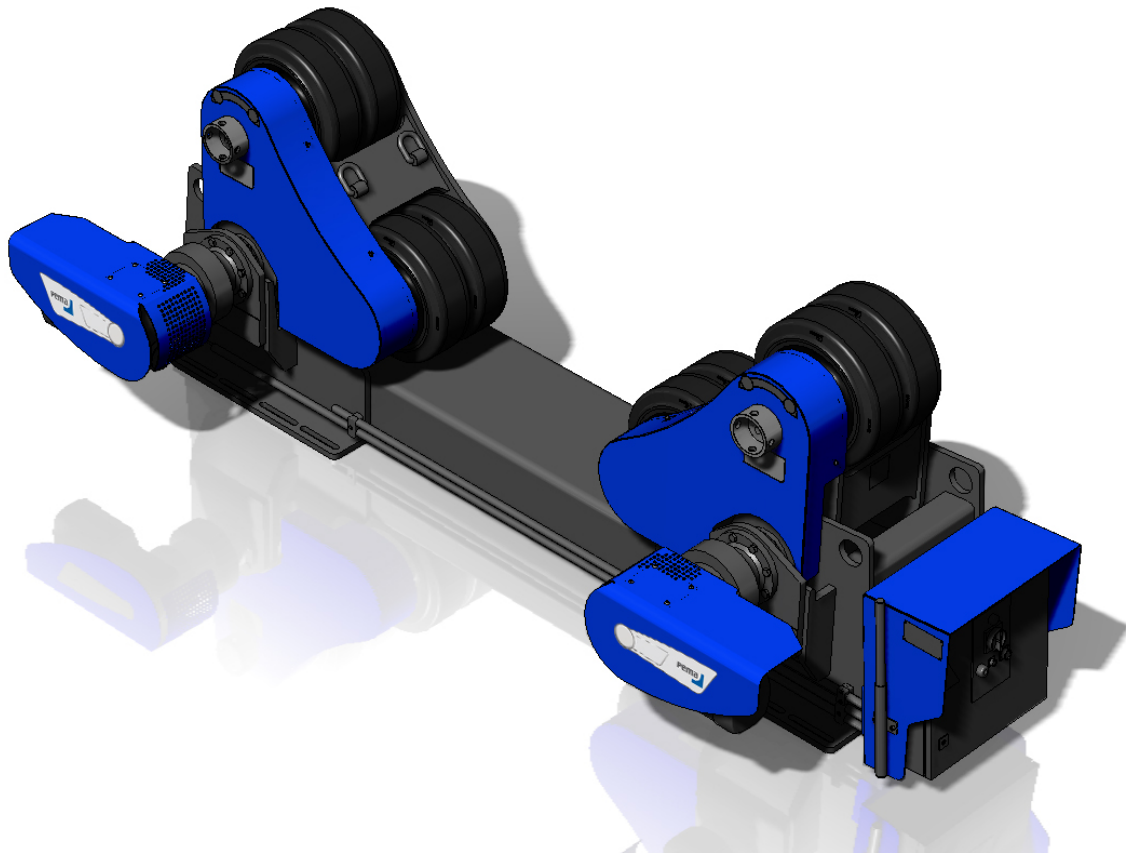

PEMA A series of self-aligning rollerbeds are ideal for handling unbalanced, thin-walled and/or heavy cylindrical work-pieces. The A series rollerbeds provide even weight distribution, constant rotation speeds and adaptability to a wide range of work-piece diameters without need for separate adjustment. Loading capacities range between 12 and 800 tons.

In PEMA A series rollerbeds, roller bogies automatically adjust to align with the diameter of the handled work-piece. Compared with other rollerbed types, PEMA A beds provide superior weight distribution. This is a significant advantage in handling of thin-walled work-pieces. A power unit is usually combined with one or several idler units.

All four axles of PEMA A80 4D drive unit are power-driven. Four-wheel drive provides excellent grip and accurate rotation characteristics even for very unbalanced work-pieces.

Work-piece movements are easily controlled with a handy 24 V remote controller. The operator can monitor rotation speeds with a digital RPM display.

PEMA rollerbeds are designed in close co-operation with the best welding production professionals. PEMA's extensive experience in designing and

manufacturing welding automation solutions has been a key factor in the development of PEMA rollerbeds. Designed to the same high-quality standards as PEMA positioners and column & booms, PEMA rollerbeds fulfil the requirements of the European EN safety norm. All PEMA rollerbeds come with CE markings.

A80 4D DRIVE UNIT

Self-aligning rollerbed with 40 ton capacity

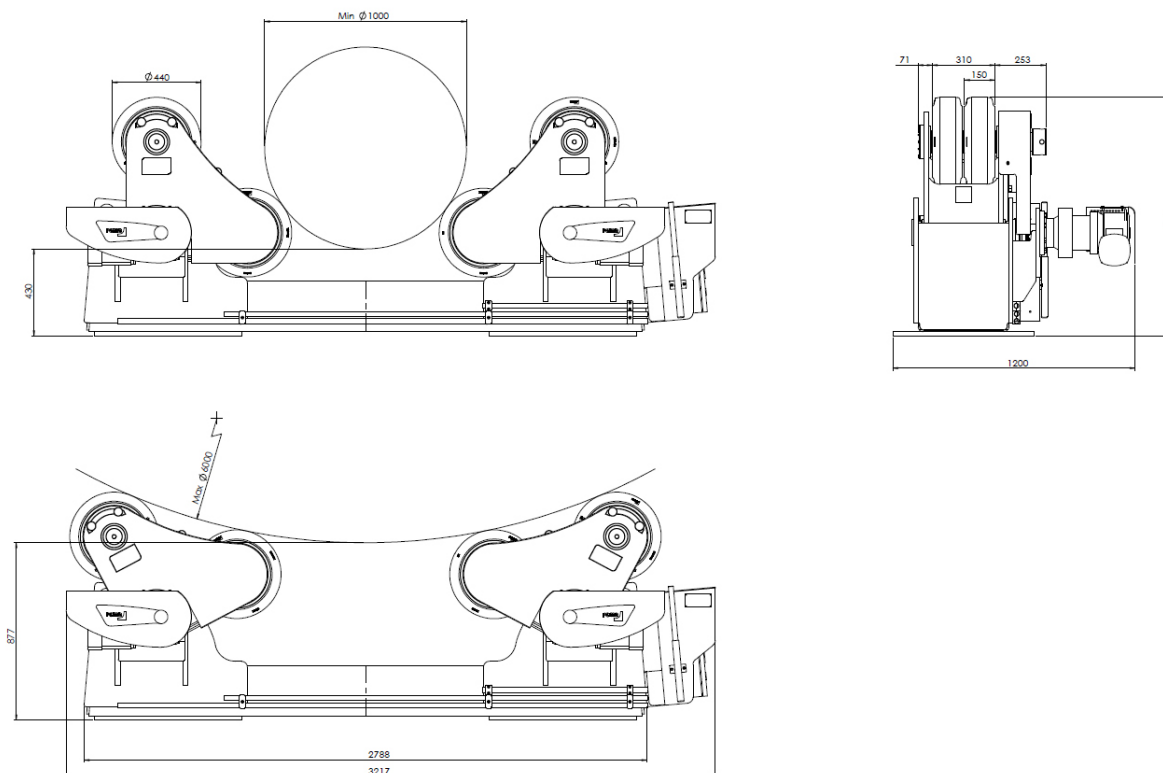

Due to continuous R&D, Pemamek Oy Ltd reserves the right to change the specification without notice.

Technical data

Max load (ton)	40
Rolling capacity (ton)	120
Max. rotation force (kN)	50
Rotation speed range (mm/min)	60-1250
Diameter range min-max 50% (mm)	1000-6000
Diameter range min-max 100% (mm)	2000-6000
Roller diameter / total width (mm)	440 / 310
Rollers (pcs)	8
Roller material	PU
Width (mm)	1210
Length (mm)	3230
Weight (kg)	2200
Mains supply connection 50 Hz	3*400V+N+PE
Power (A)	25

Optional accessories

- Foot pedal for start/stop of rotation
- Foot pedal for speed control of rotation
- External control of rotation
- Rail car units

PEMAMEK OY LTD

Lamminkatu 47, FI-32201 Loimaa, Finland
 Phone: +358 2 760 771 Fax: +358 2 762 8660
 e-mail: pema@pemamek.com www.pemamek.com